

B. P. R. REG. NO.	STATE	PROJECT NUMBER	SHEET NO.	TOTAL SHEETS
1	MAINE	1-95-8 (62)	26	99

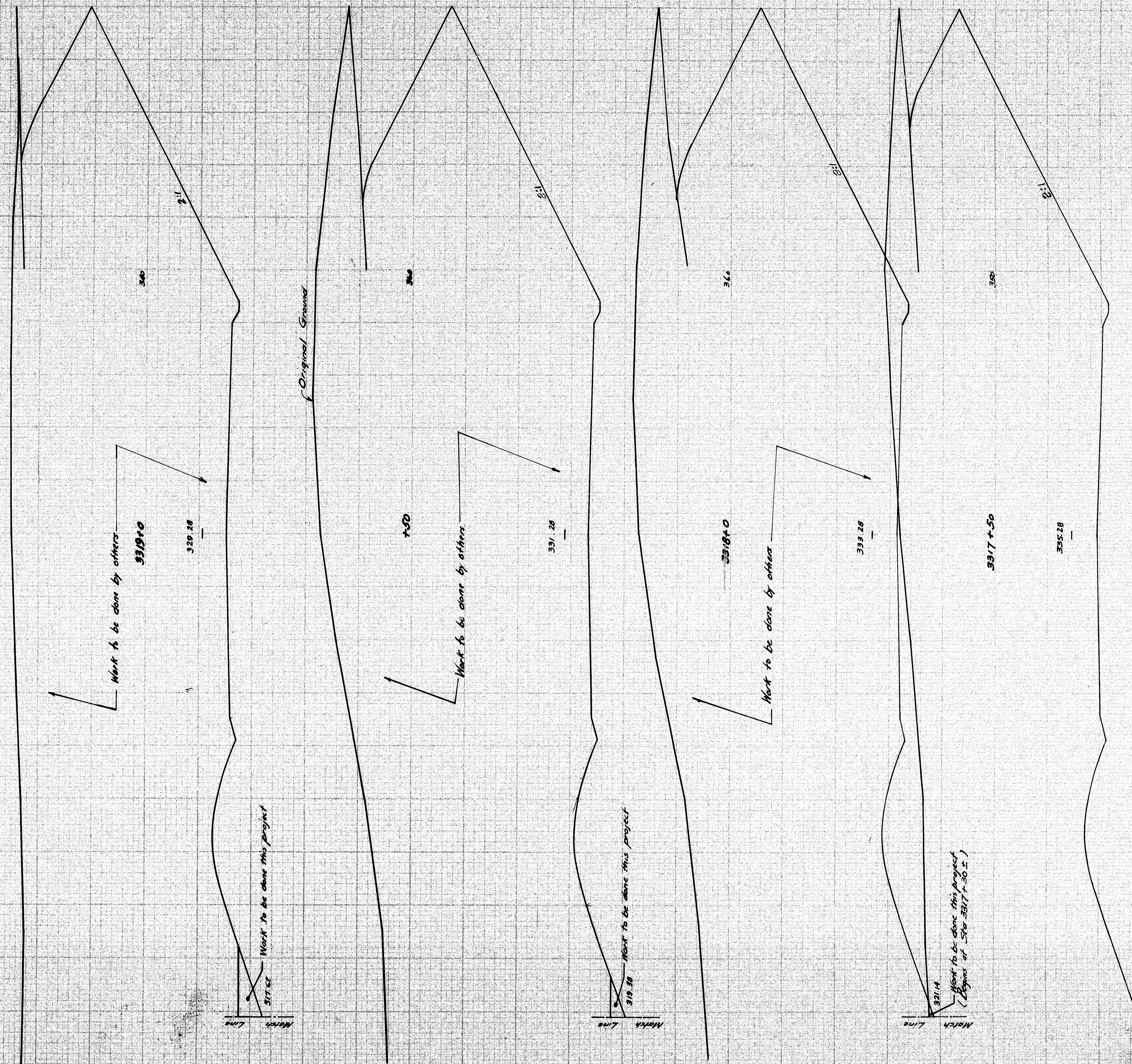
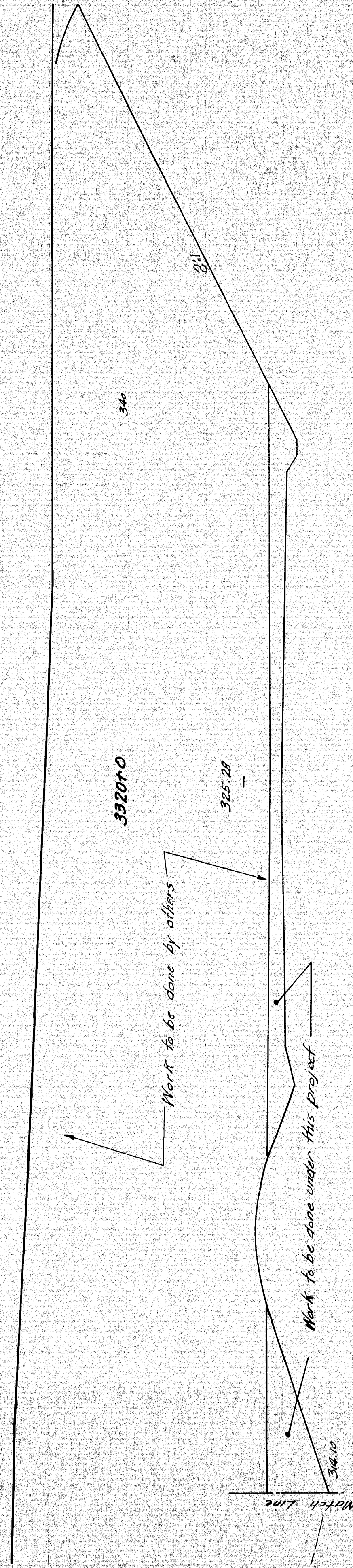
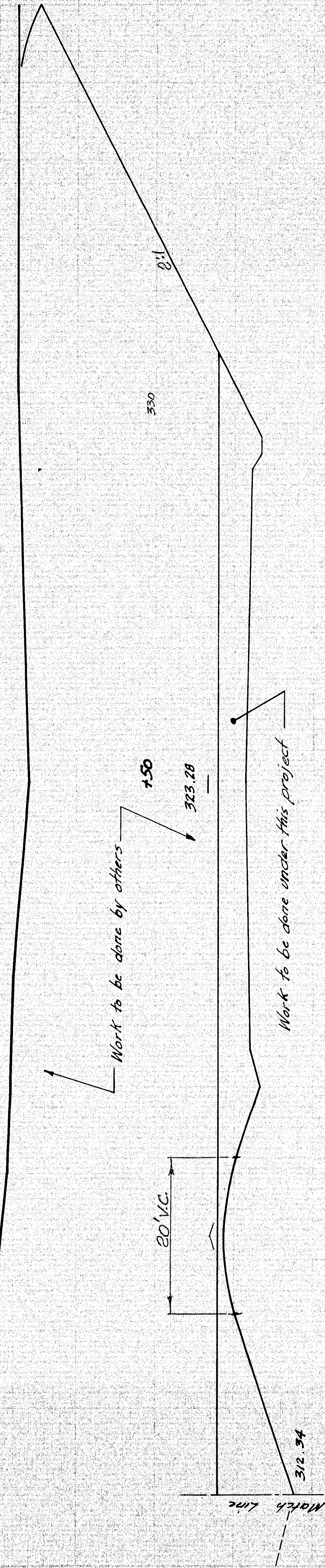
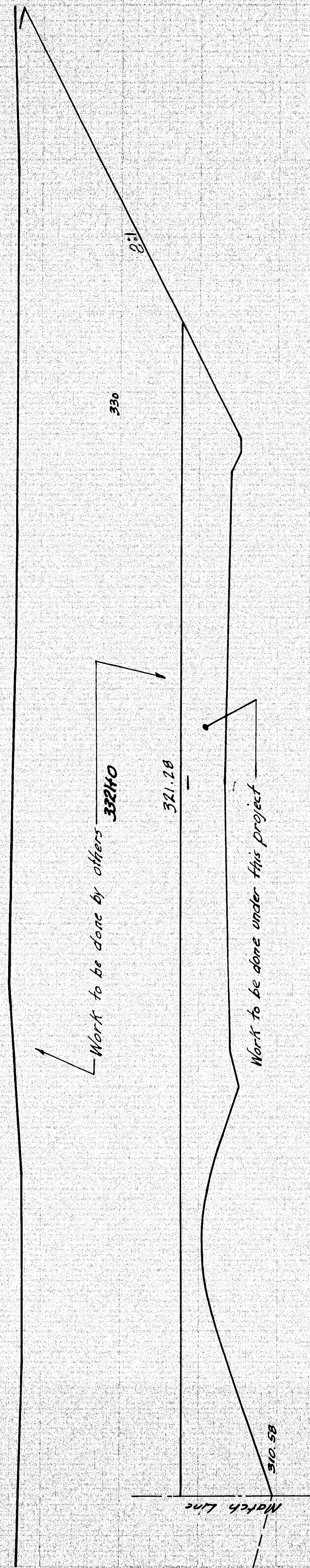
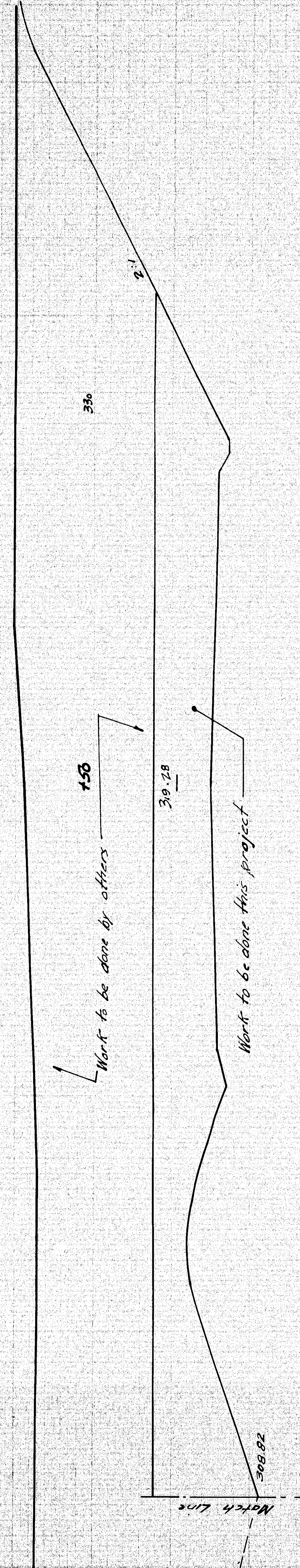

PLATE 3 - CROSS SECTION (A, B, C, D, E)
SCALE AND ELEVATION IN FEET
CHARTERED ENGINEERING COMPANY, INC.

SCALE
Hori. & Vert. : 1" = 10'

MEOWAY

331.7+50 to 335.28+0 1/2



Begin Road Lay. Elevation Graded
Ditch 42 Right 546.23/19/25

Place Jute Matting Weave 14"
in Left Ditch 42
546.23/19/25 to 546.23/26+25

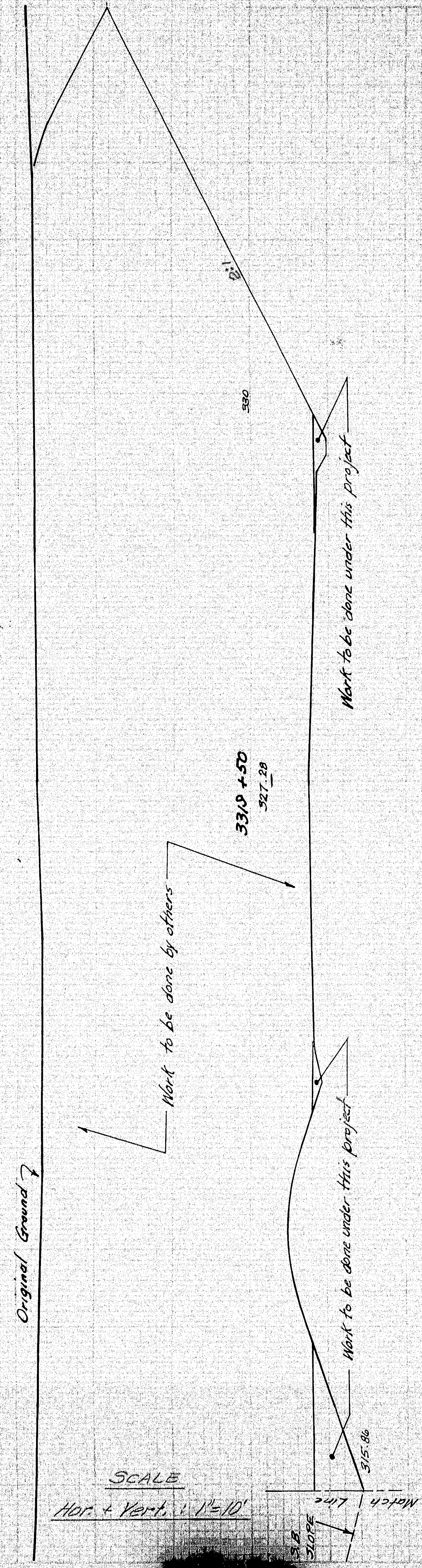

Original Ground

SCALE
HOR. & VERT. 1" = 10'

MEDWAY

5319+50 - 3321+50 1/4

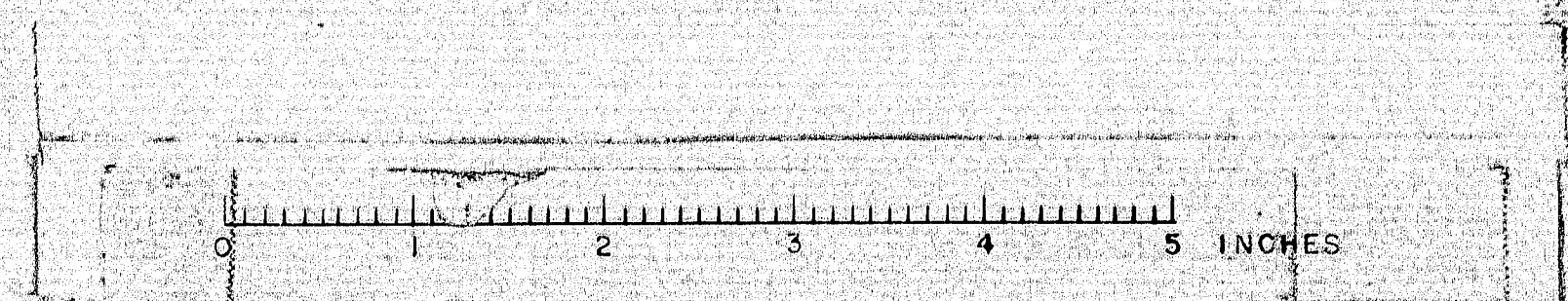
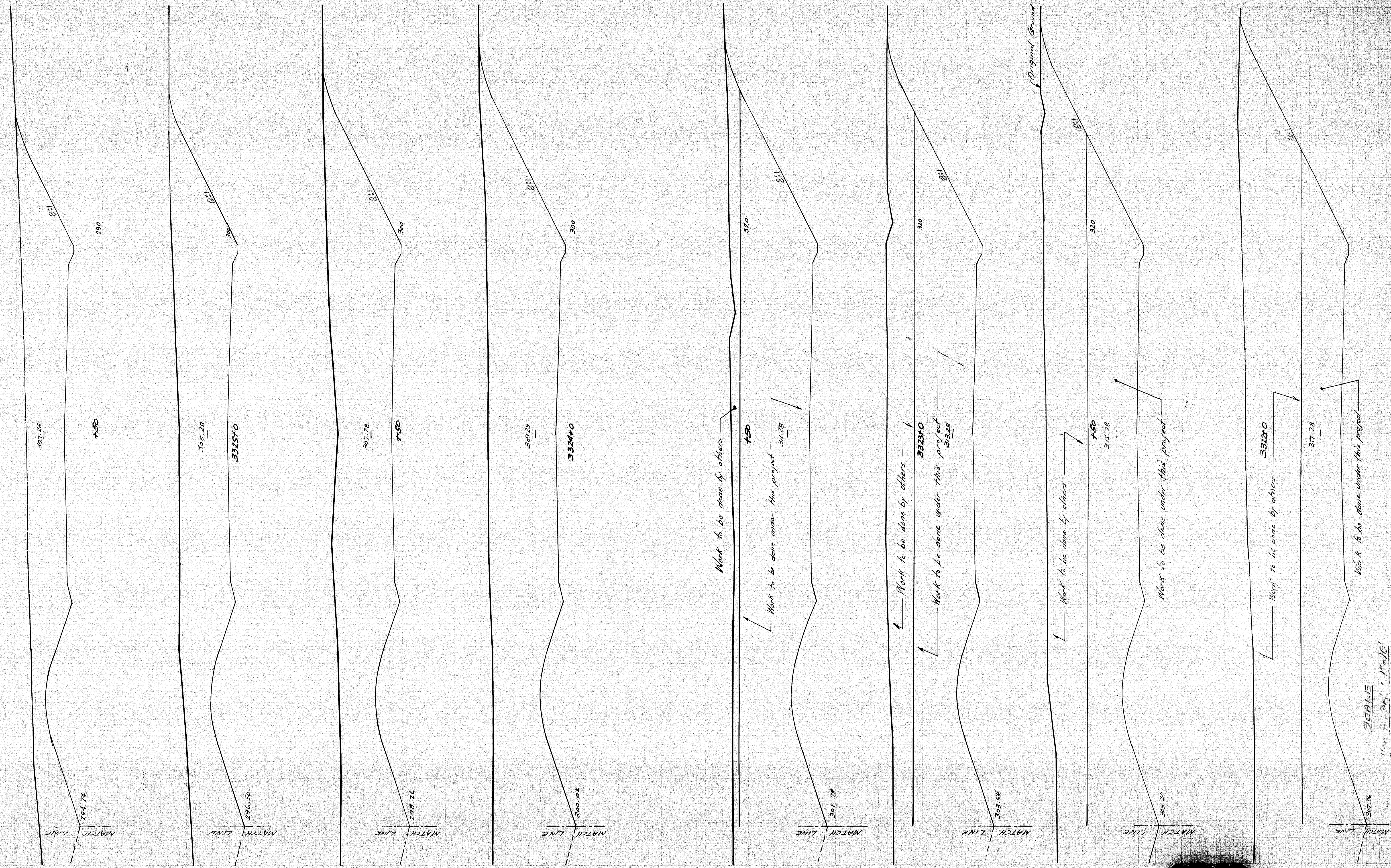

SCALE
1" = 20'

2 Bearing About 71° E-25' over Rte 116 Sta 3332+22.80 N.E.

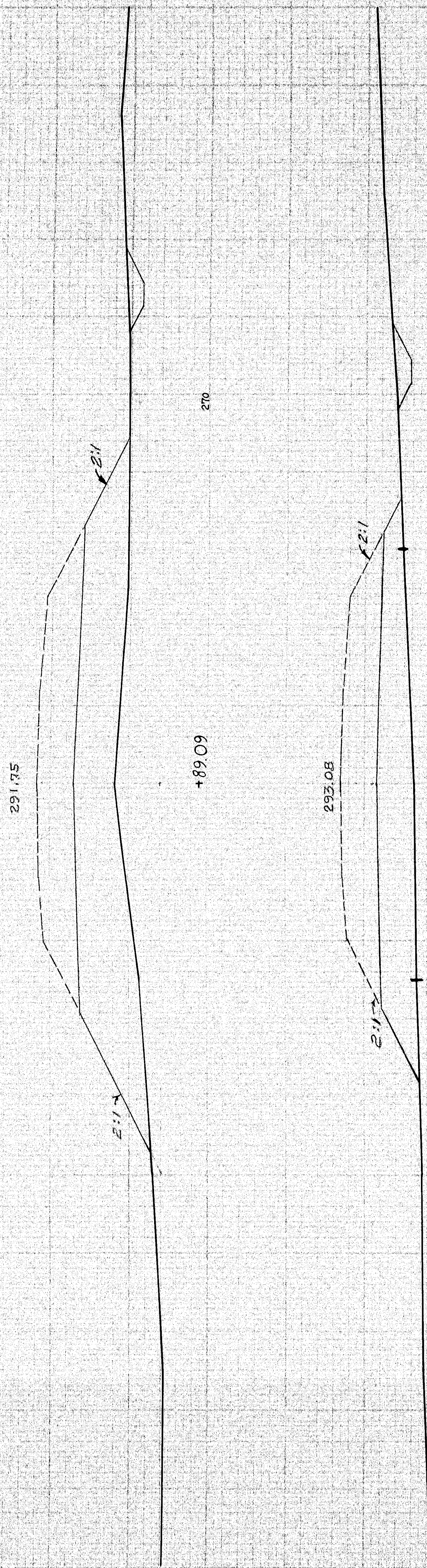

3331+39.09
Sta. 3328+10.91 Bk = Sta. 3331 + 00.00 Ahd.
E_g = -289.09'

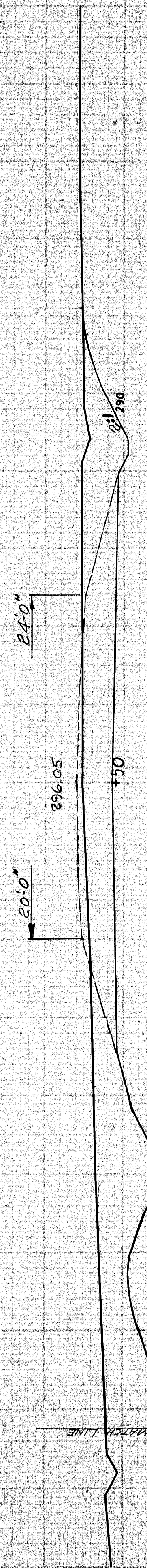
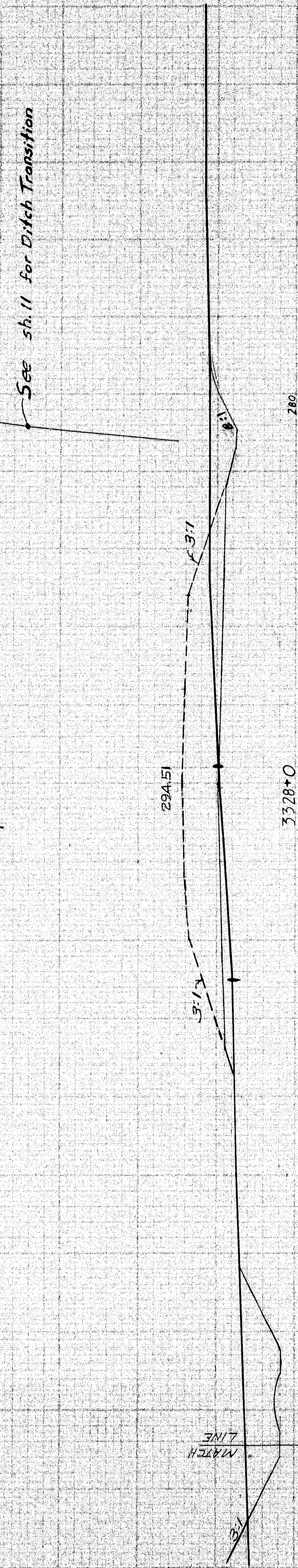

START GUARD RAIL @ STA 3327+25+ BOTH SIDES
(By Others)

14' @ Sta 3327+25
20:0' @ Sta 3327+25

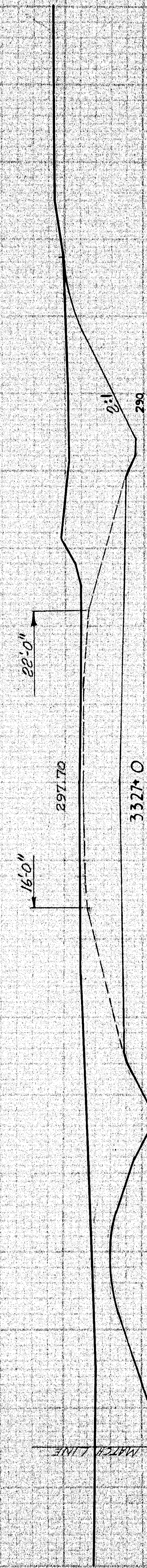

Left Ditch N.B. Sta. 3326+80
Begin Hand Land Right, Graded

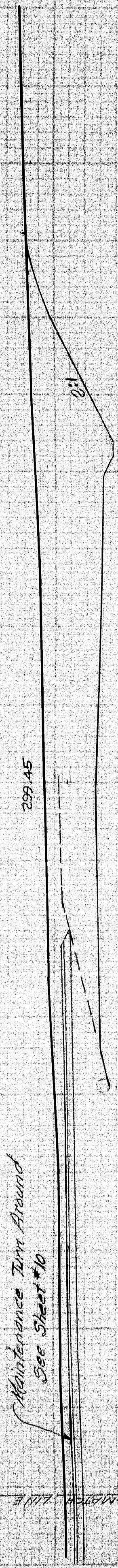

Left Ditch N.B. Sta. 3326+25
End Jute Matting Means H'

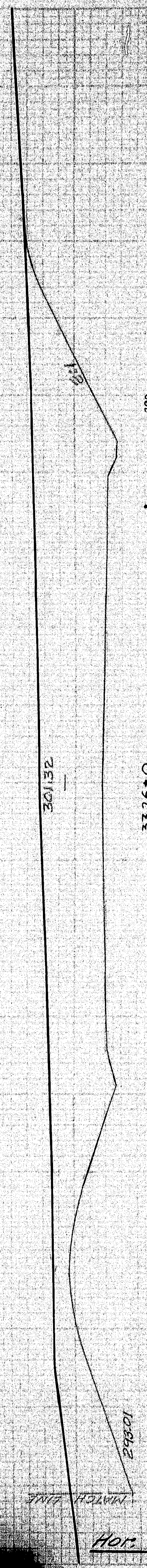

B. P. R. NO.	STATE	PROJECT NUMBER	SHEET NO.	TOTAL SHEETS
1	MAINE	1-95-8 (62)	28	93

SCALE
Hor. & Vert. 1"=10'

DATE

Conc'd & Hill 7/16/64

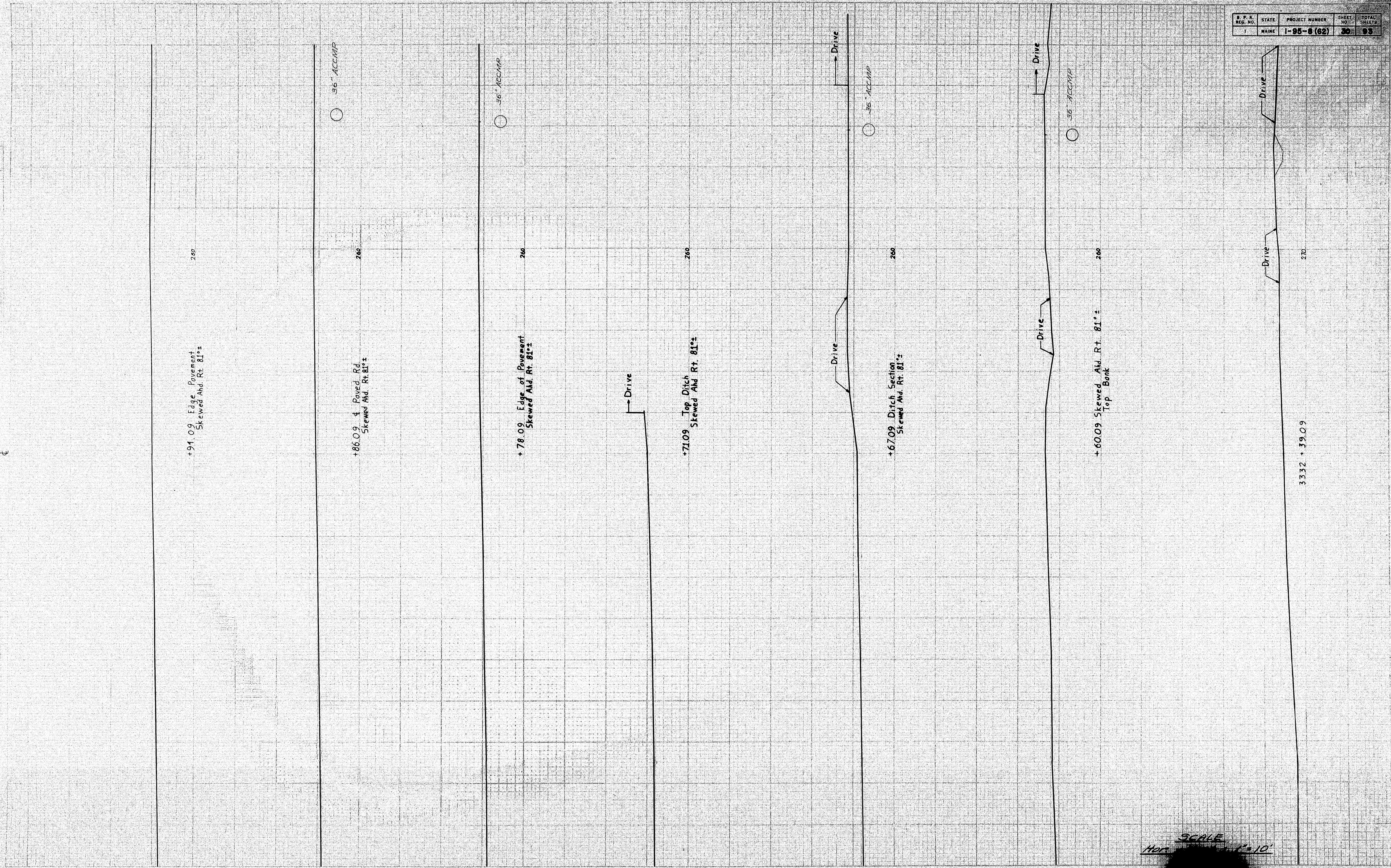

D. P. N.	STATE	PROJECT NUMBER	SHEET NO.	TOTAL SHEETS
1	MAINE	1-95-8 (62)	30	93

PLATE 1 - CROSS SECTION A. S. R. R. I.

SCALE
HORIZ. 1" = 10'



3332 + 39.09 - 3332 + 91.09 N.

7/15/64
Gosselin & H. II

SCALE
Hor. + Vert. : 1" = 10'

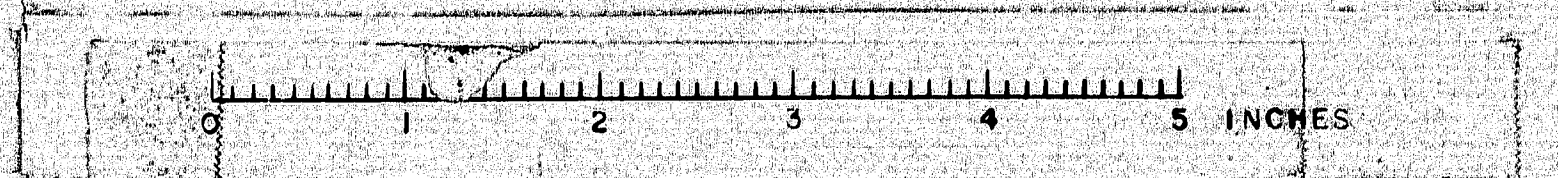
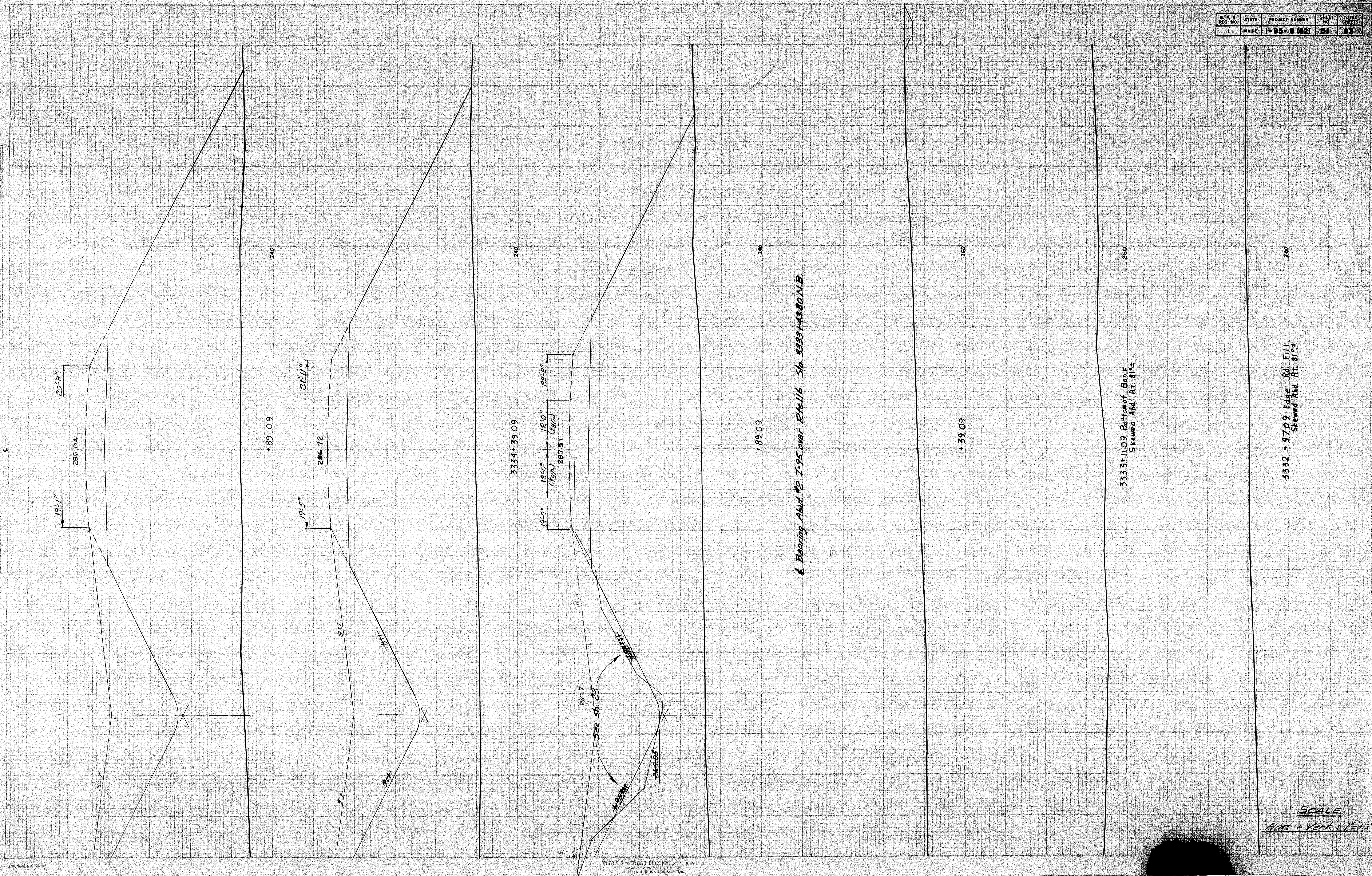

33332 + 97.09 - 33334 + 89.09 N₆

DATE	
BY	
FINAL SURVEY	
REVISION	
NO.	

DATE	7/15/64
BY	Gosselin & Hill
PROJECT	
NO.	

DATE	7/15/64
PROJECT NUMBER	1-96-0 (62)
SHEET NO.	22
TOTAL SHEETS	93

Sta. 3335+41.12 U.B.
 End Construction Project I-95-8(62)
 Begin Construction Project I-95-9(29)

3336+59.09

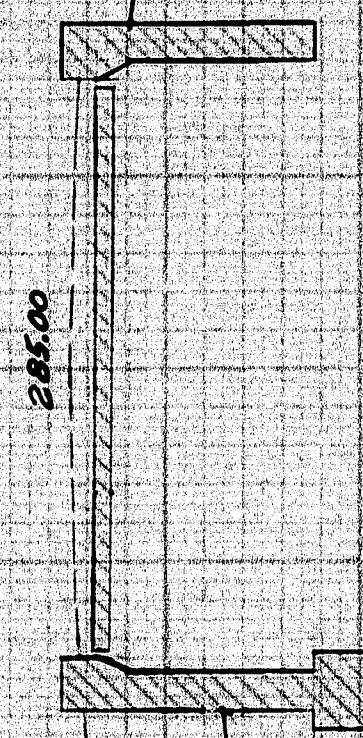

Begin Hand Load Elevation
 Elev. Sta. 3335+44

184.23



3335+39.09

SCALE
 Hor. & Vert. 1"=10'

PLATE 3-CROSS SECTION
 DRAWING COMPANY, INC.

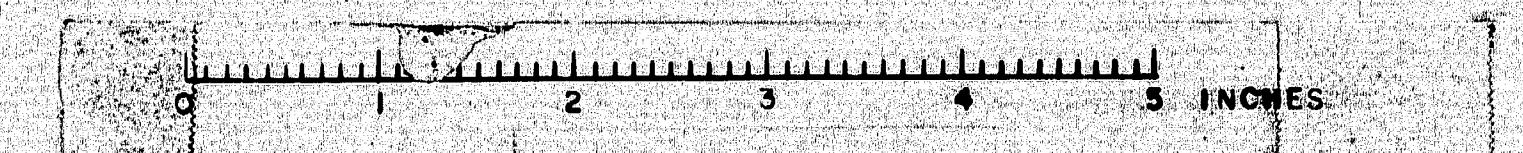

3335+39.09 - 3336+59.09 No

DATE: _____
 BY: _____
 CHECKED: _____
 APPROVED: _____

CONTRACT NO. _____
 PROJECT NO. _____
 SHEET NO. _____

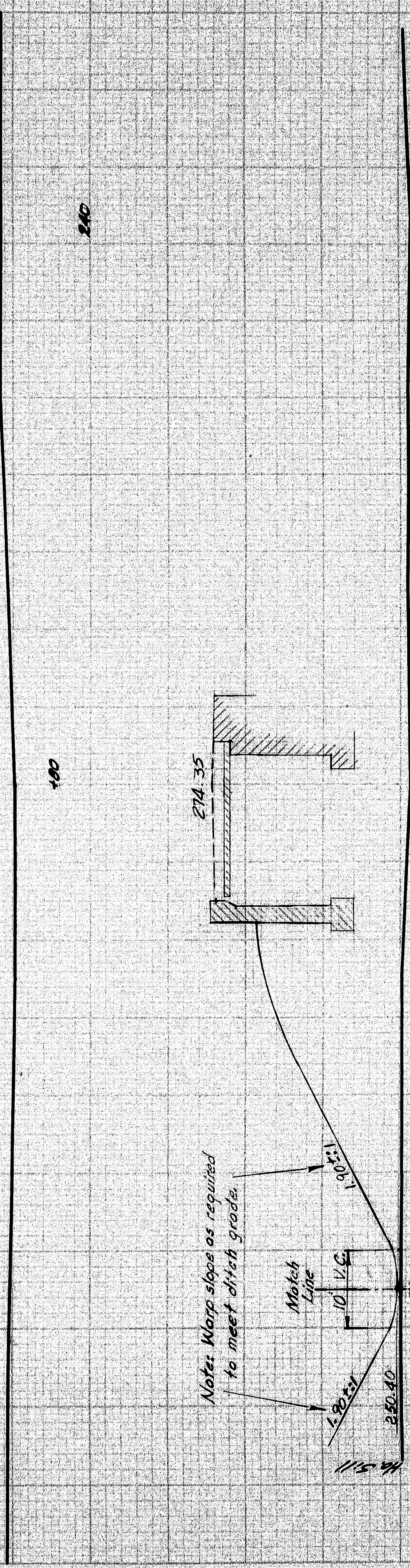
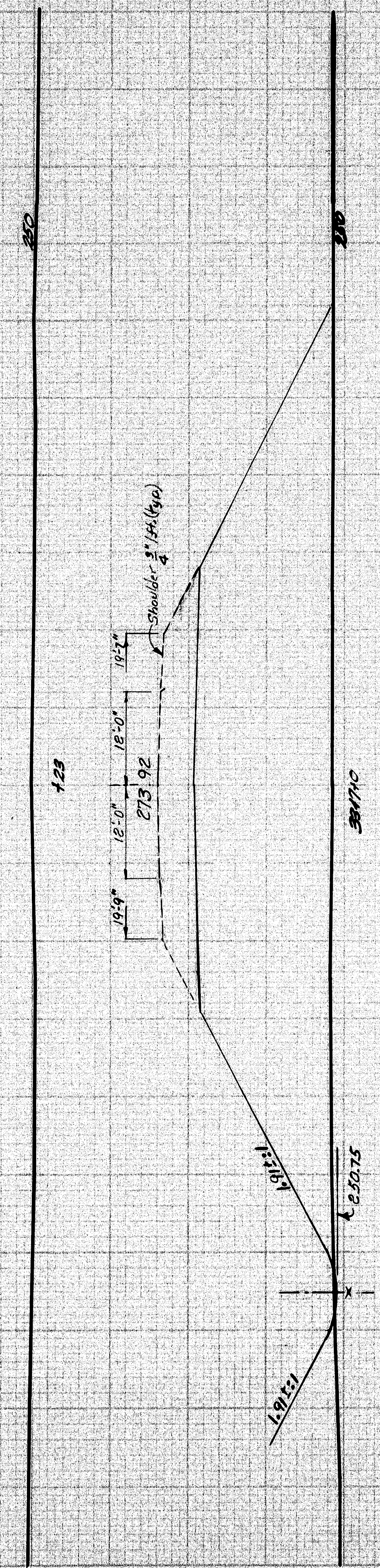
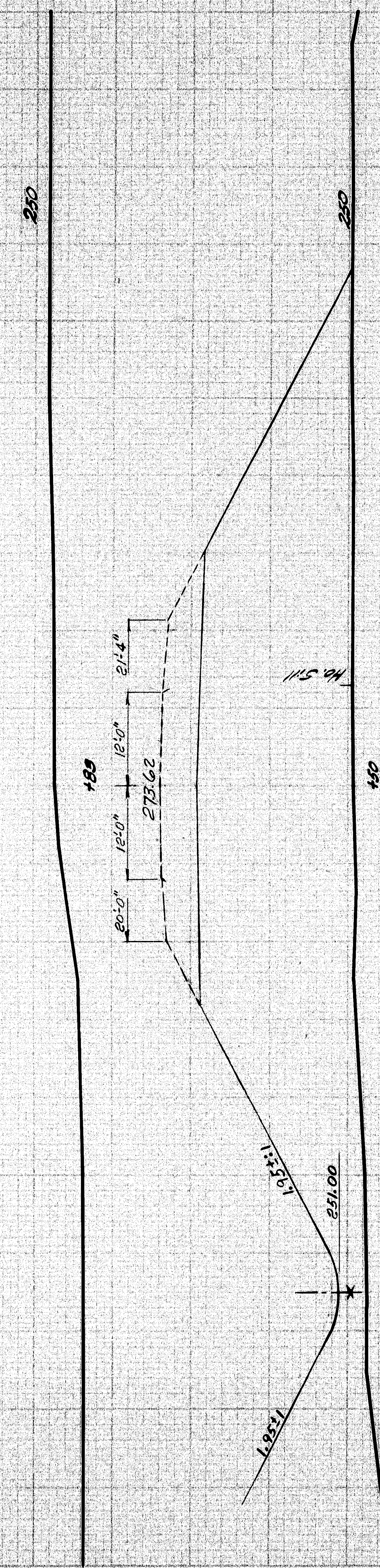

Boarding Abut. No. 1-87
 over Footcut River Sta. 3348+44.89 V.B.

Note: Matching (3 Straps Wide)
 in Median from Sta. 3348+44.89 V.B.
 to Sta. 3348+50.00 V.B.

SCALE
 Hor. = Vert. = 1" = 10'



PLATE 3 - CROSS SECTION - S. P. N. 1
 JOHN A. BROWN & SONS, INC.
 CHARLES BROWN COMPANY, INC.

MEDWAY

DRAWN BY: [illegible]
 CHECKED BY: [illegible]
 DATE: [illegible]

PROJECT: [illegible]
 SHEET: [illegible]

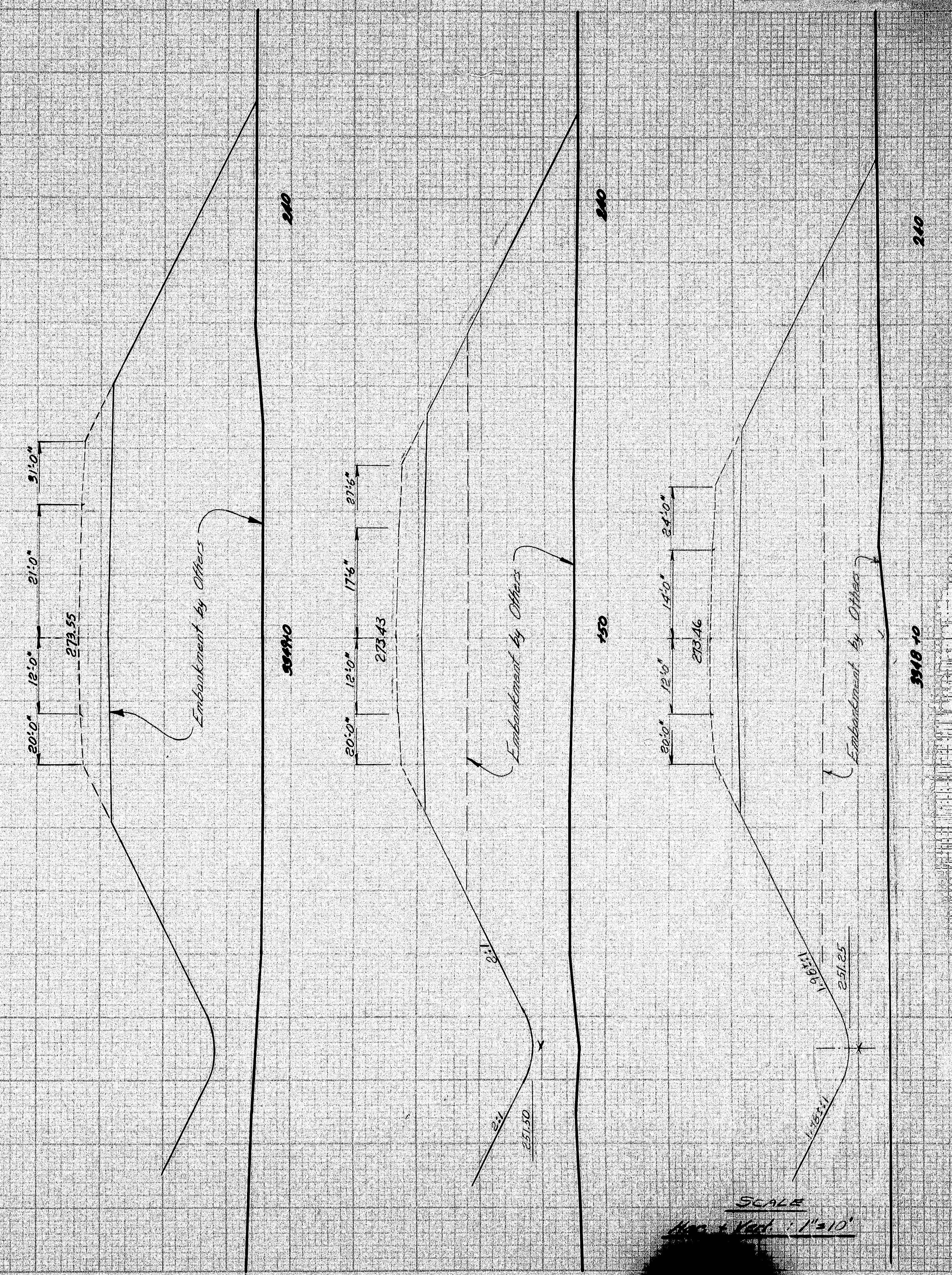
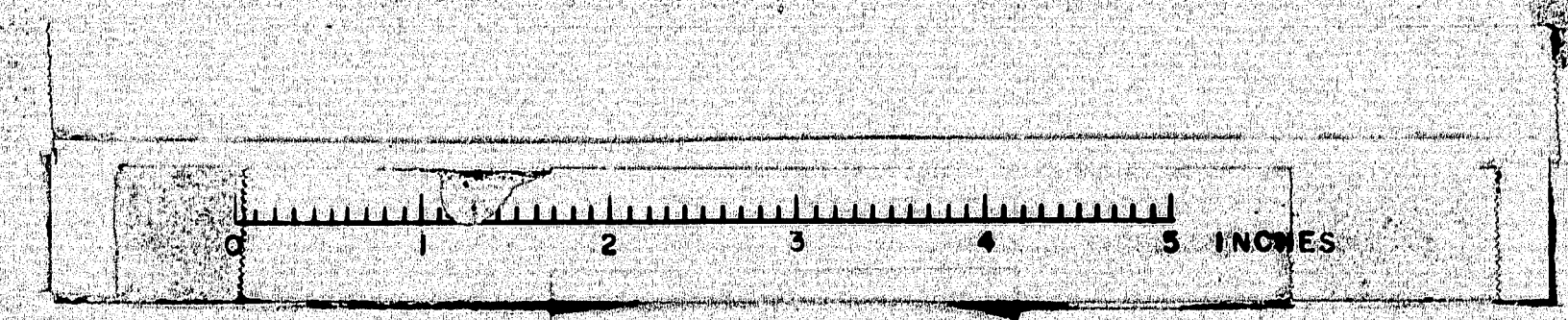

PLATE 3 - CROSS SECTION - G. P. S. S. L.
 G. P. S. S. L. - G. P. S. S. L.

SCALE
 1" = 10'

MEDWAY



1/4" = 10' to 100' 1/8"

D. P. R.	STATE	PROJECT NUMBER	SHEET NO.	TOTAL SHEETS
1	MAINE	1-95-8 (62)	35	93

Underdrain - not perforated
Sta. 53+40, off 25' 3/4" Left
to ditch 9 Sta. 54+30, off 110' Right.

Underdrain - Perforated
Sta. 51+80, off 65' 3/4" Left
to Sta. 53+60, off 25' 3/4" Left.

For details of Underdrain
see Route 116, Pier sheet, (59)
Underdrain will be paid for
under Item 606-10,
Underdrain - Type "B".

POLE WORK BY UTILITIES

Remove {existing 22 thru 28} and Place {permanent P17, P18, P19, T20, T21, T22} at start of work.
(To be no Pole #20)
Remove {temp. T19, T20, T21, T22} and Place {permanent P19 & F21} at end of work.

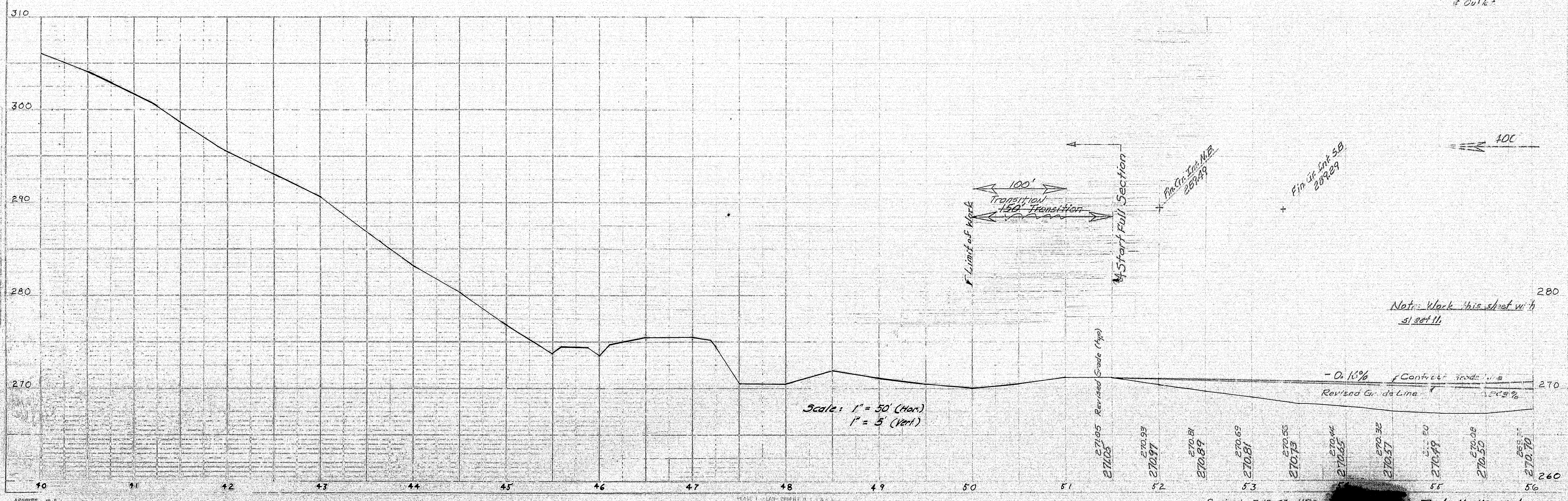
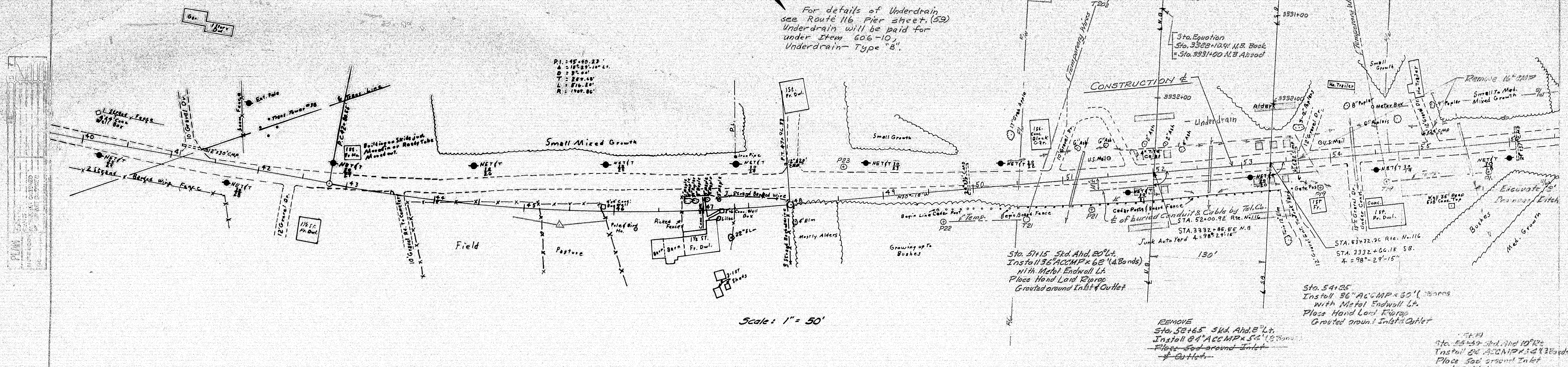

Note: Work this sheet with
Sheet 11.

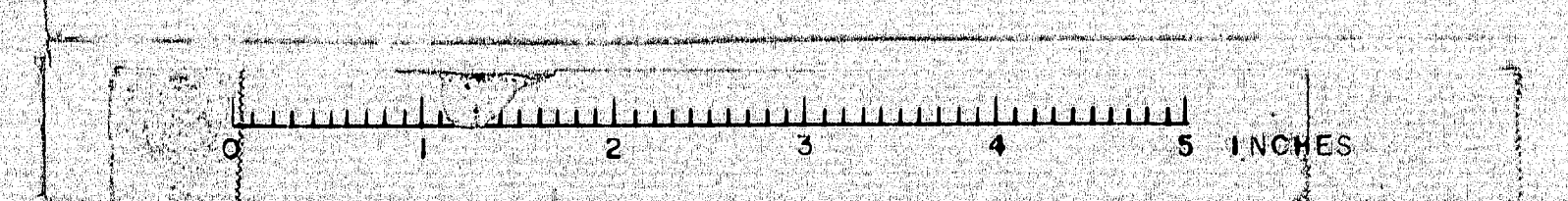

DATE	
BY	
CHECKED	
APPROVED	

DATE	
BY	
CHECKED	
APPROVED	

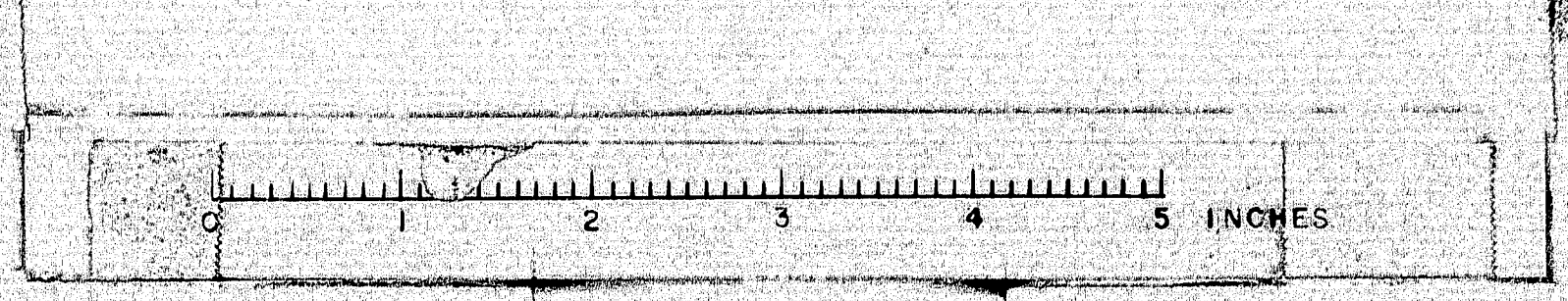
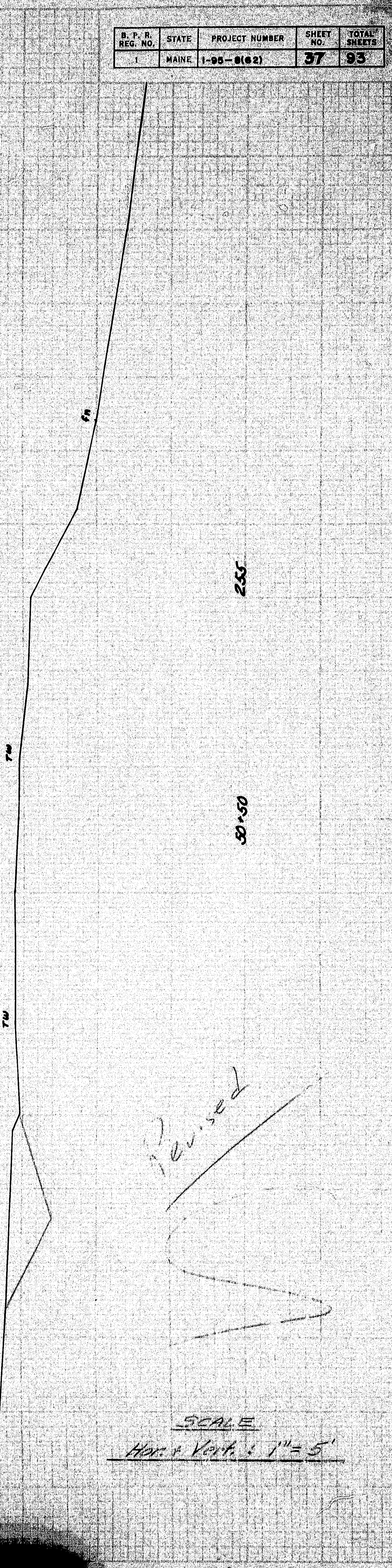
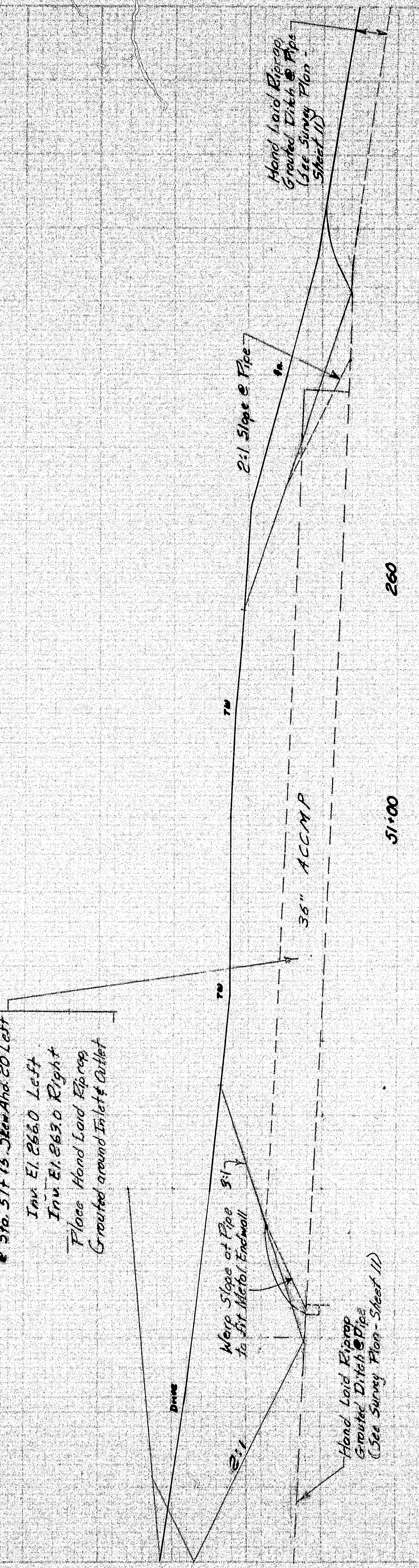
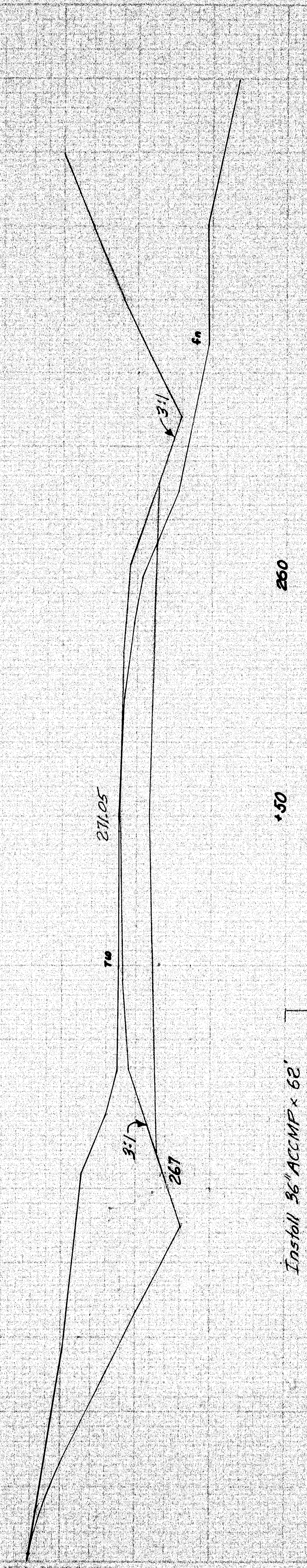
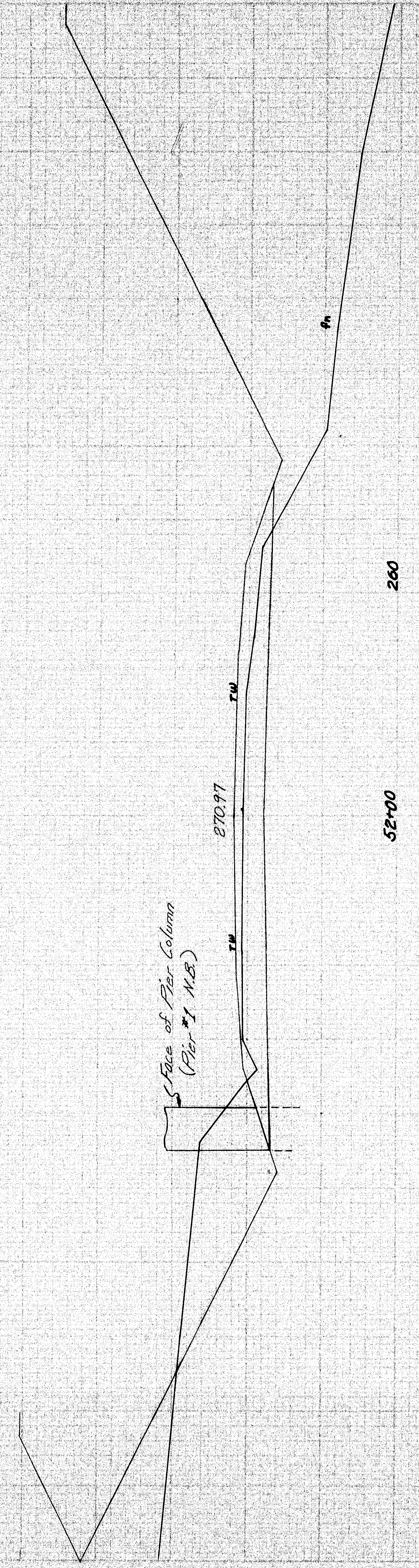
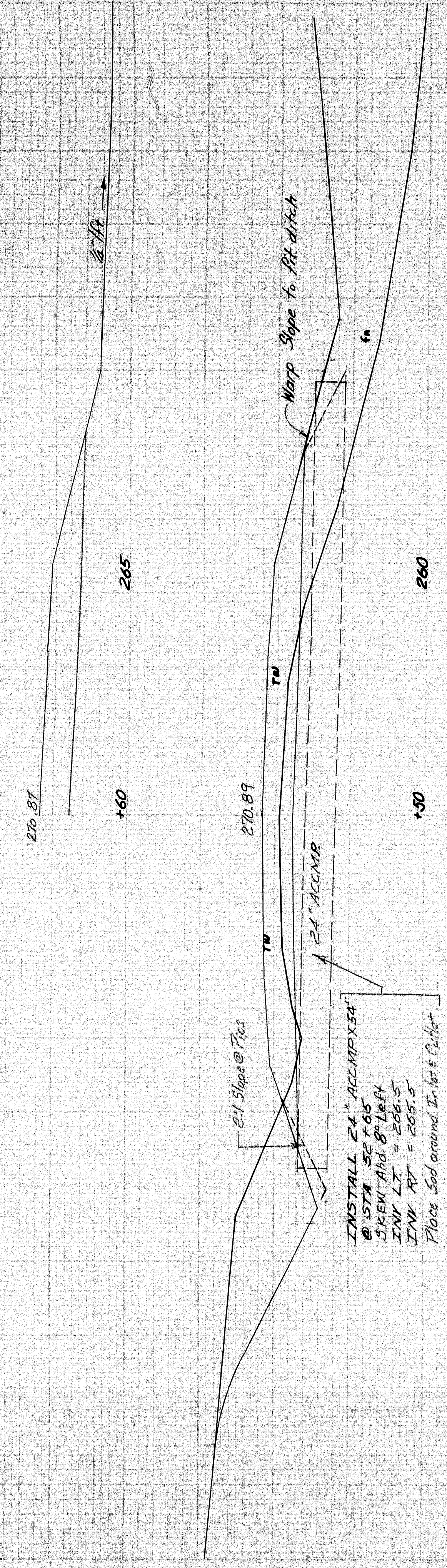

SCALE
Horizontal & Vertical: 1" = 5'

Route No. 116 Medway

Sta. 270.50 - 272.50

N. P. R. REG. NO.	STATE	PROJECT NUMBER	SHEET NO.	TOTAL SHEETS
1	MAINE	1-95-8 (62)	38	93

Install 36" x 12' CMP @ 50' with Man. Entrance @ Sta. 54+35
Inn. El. 884.5
Place Man. Load Pipe, Grouted End @ Pipe, Grouted around Inlet & Outlet

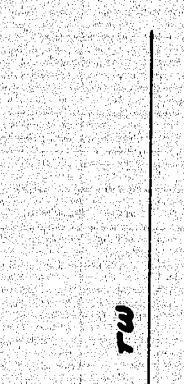
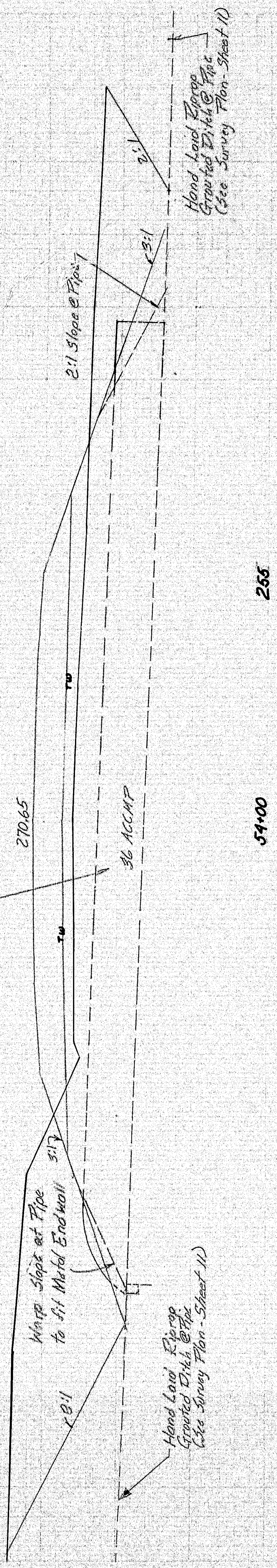

12' Gravel Drive Left Skewed Ahead

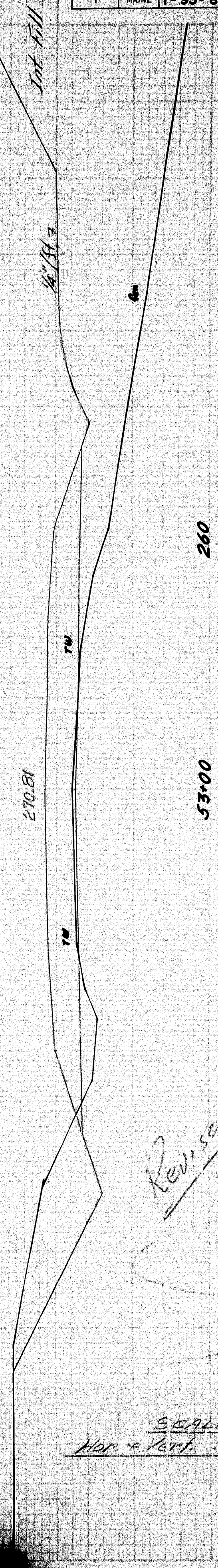
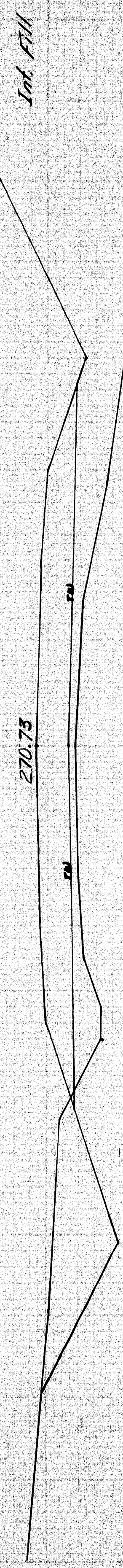
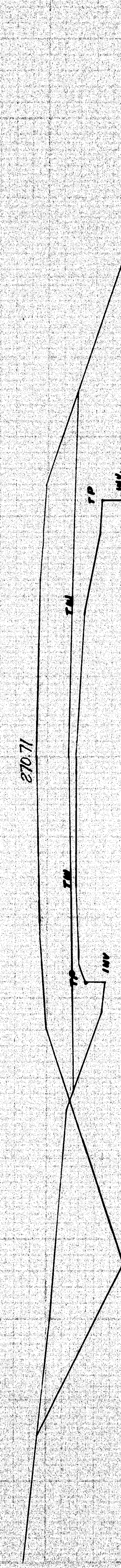

SCALE
Hori. & Vert. : 1" = 5'

Revised

Route No. 116 Madway

Sta. 53+00 - 54+00

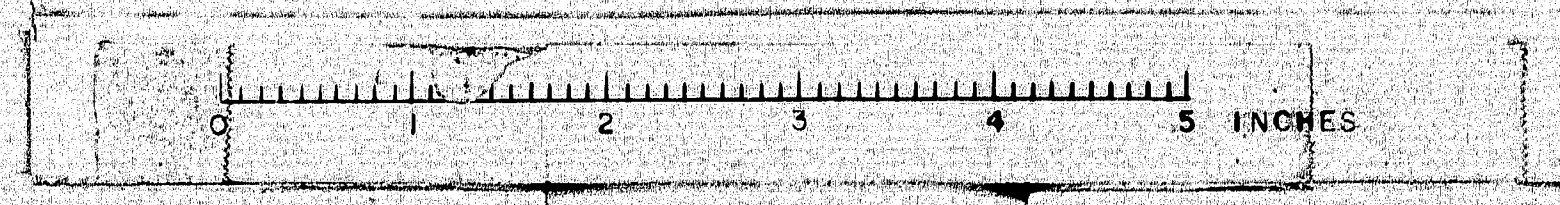

B. P. R. REG. NO.	STATE	PROJECT NUMBER	SHEET NO.	TOTAL SHEETS
1	MAINE	1-95-8 (62)	39	93

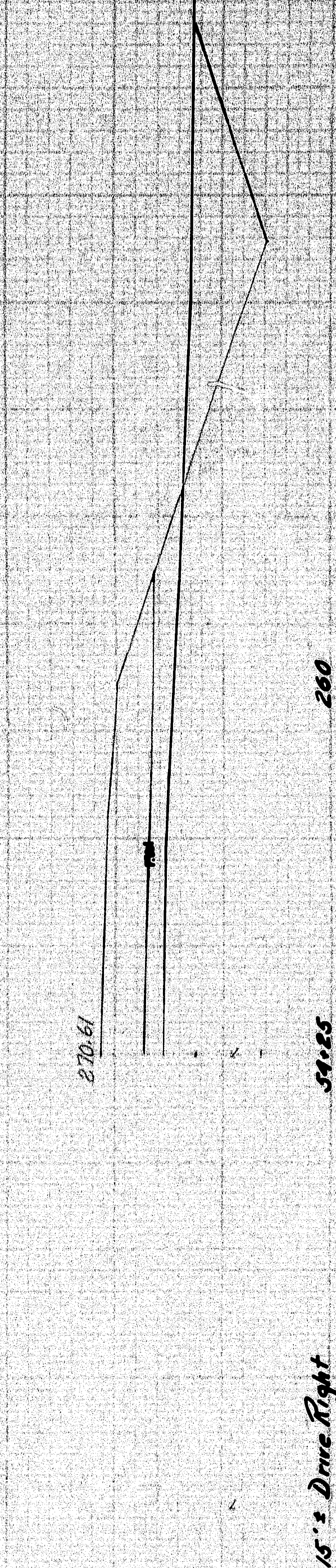
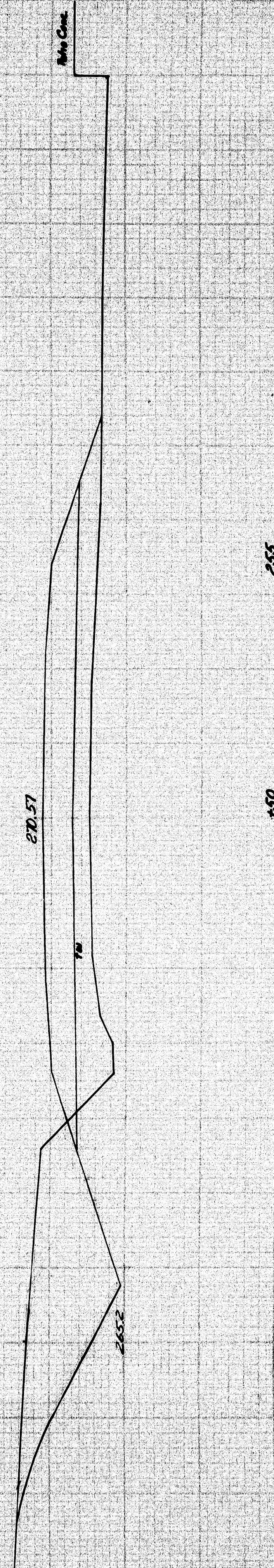
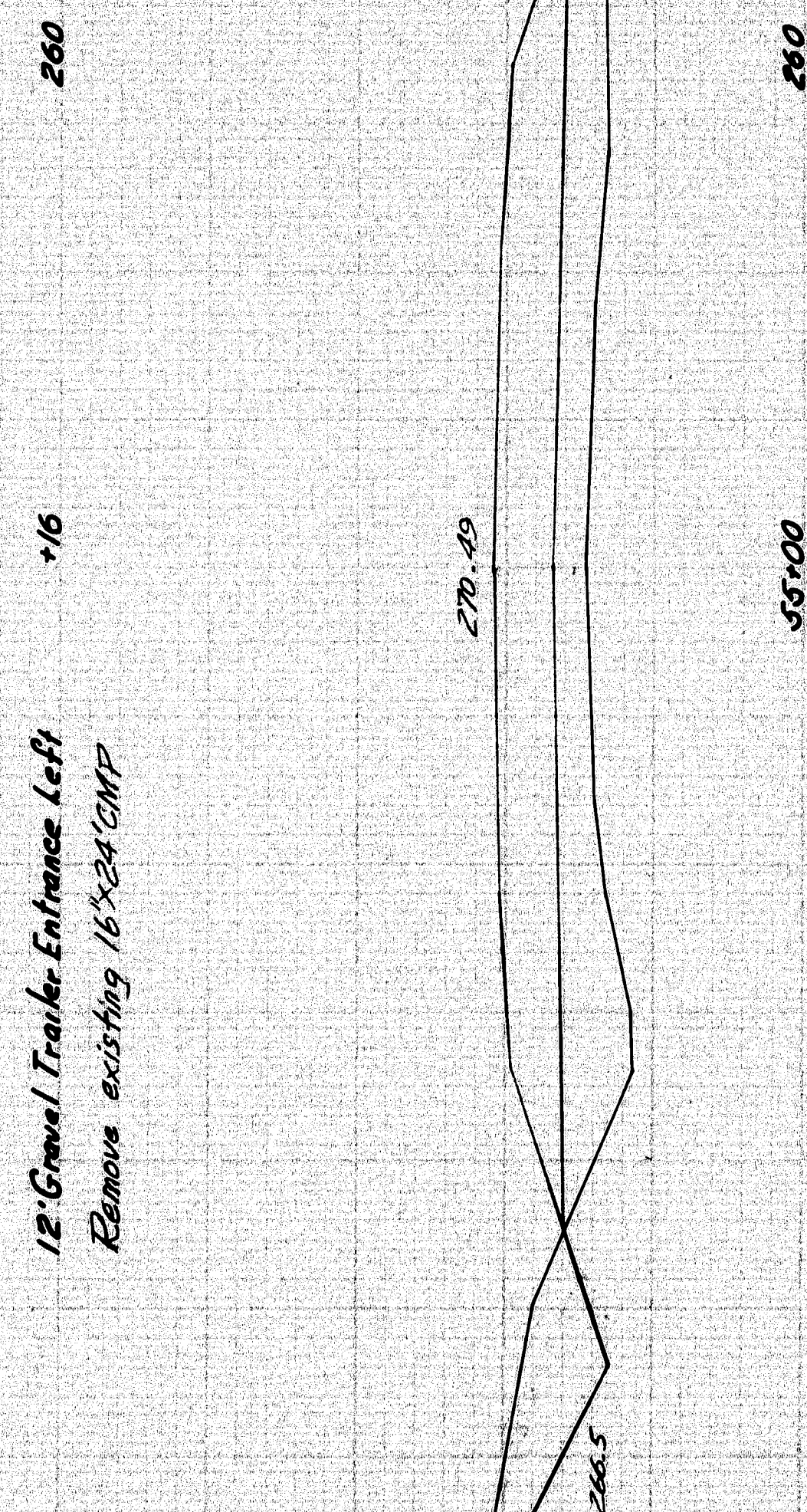
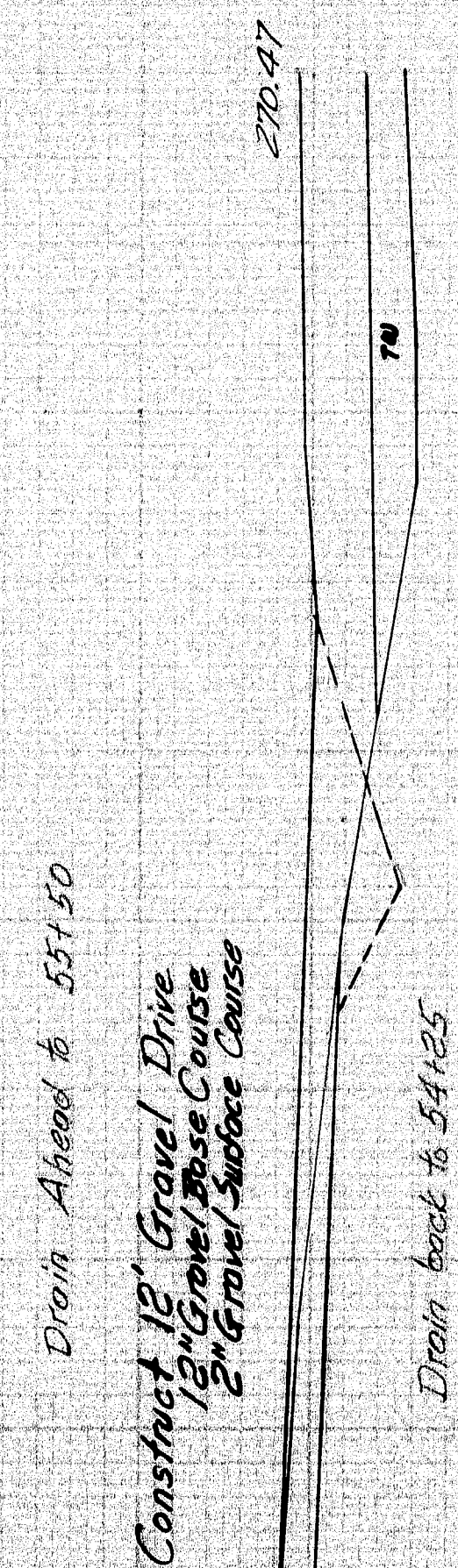
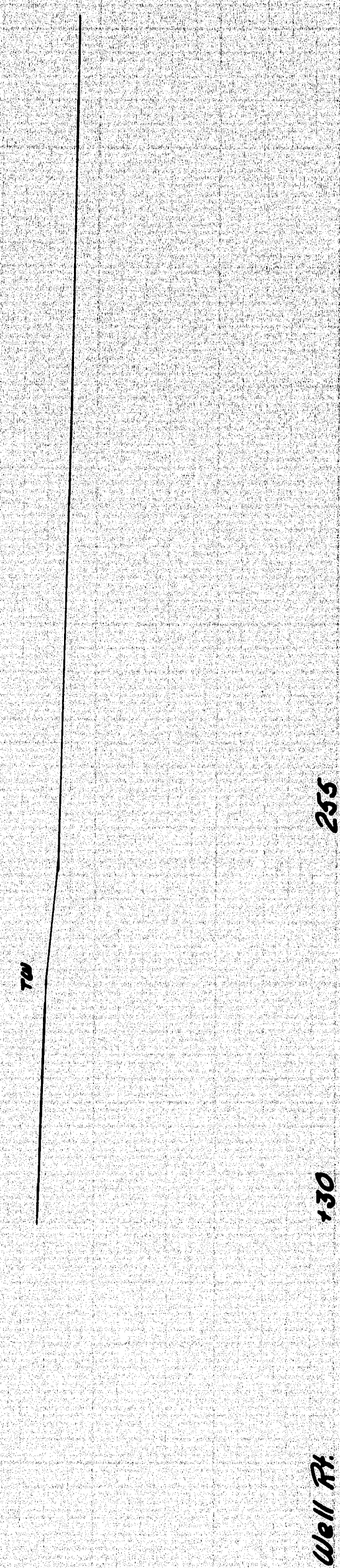
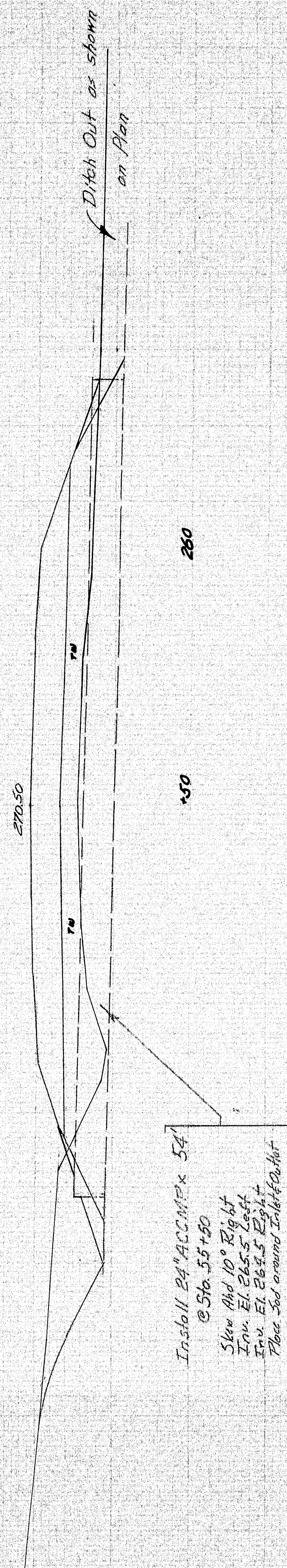

Revised

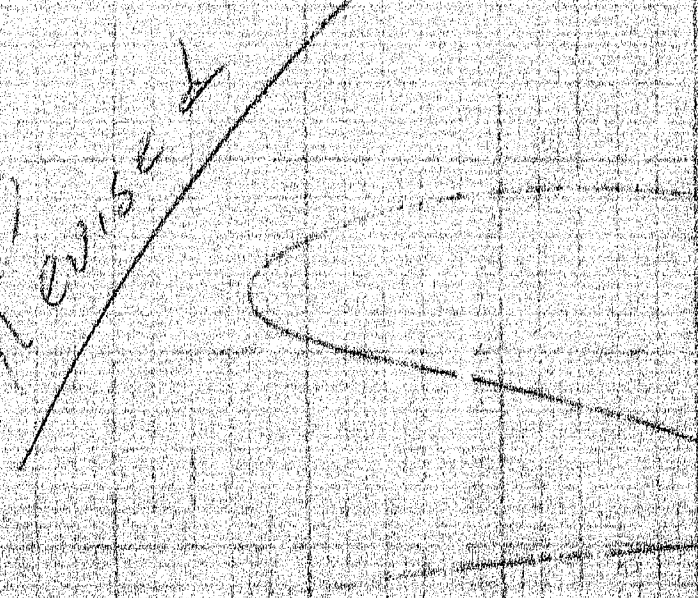

SCALE
Hor. & Vert. $1" = 5'$

SCALE
Hor. & Vert. $1" = 5'$

Route No. 116 Medway

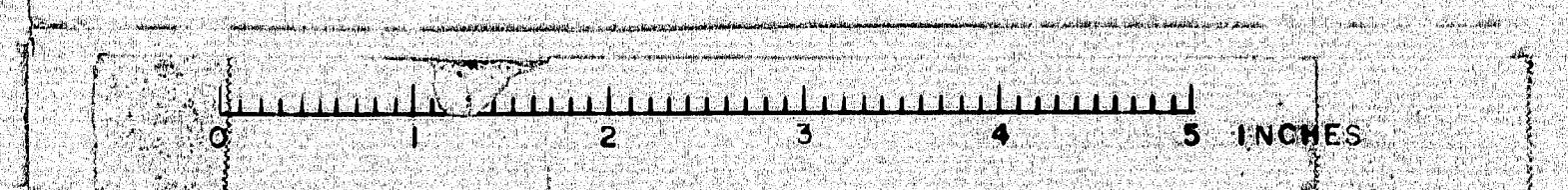

R. F. R. REG. NO.	STATE	PROJECT NUMBER	SHEET NO.	TOTAL SHEETS
1	MAINE	95-8 (62)	40	95

DATE	BY	CHECKED	DATE

DESIGNED BY	DATE	APPROVED BY	DATE

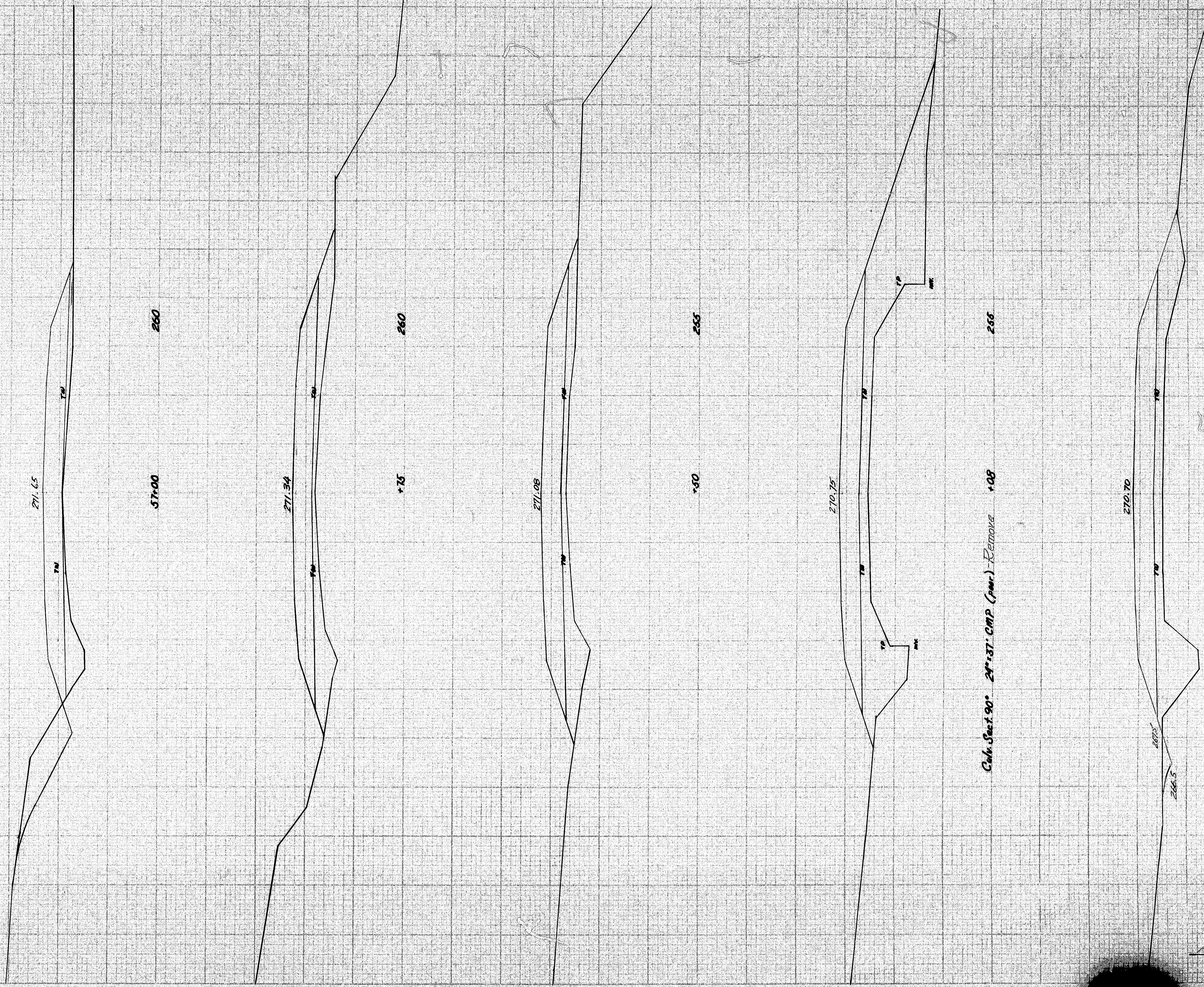

Cut Sect 90° 24°37' CMP (pm) - Remove 108

Rev. 10/5/51

SCALE
Hor. & Vert. 1" = 5'

Route No. 116 Medway

PLATE 3 - CROSS SECTION
MADE BY THE STATE OF MAINE
DESIGNED BY GEORGE C. GIBSON, INC.

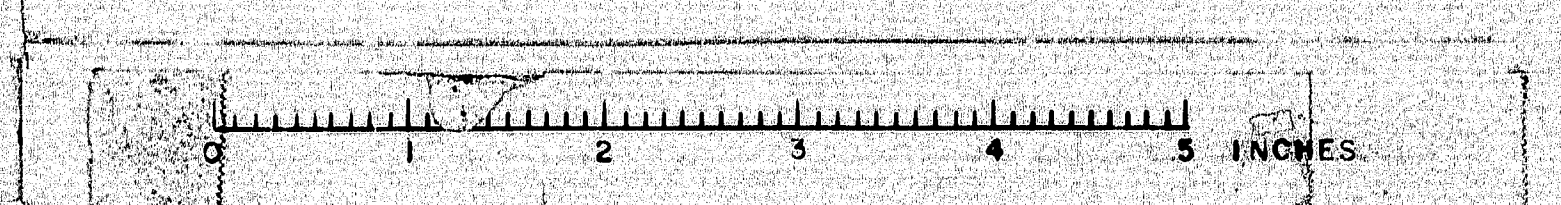

574.00-574.00